

SPECIFICATION (50Hz)

Voltage (V)	415
Watt (W)	245
Amps (A)	0.87
Speed (rpm)	1450
Capacitor (μ F)	---
Airflow (m^3/hr)	3350
Noise (db)	75
Net Weight (Kg)	8.25

PERFORMANCE CURVE

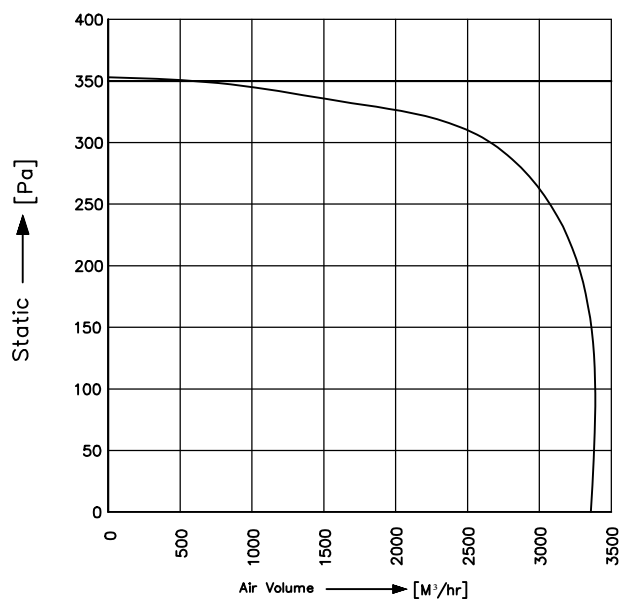

Conversion: 100pa \approx 0.4" H2O 100m³/hr \approx 60cfm

ROTECH Material :

- Impeller: Aluminum, powder coated
- Rotor: Powder coated
- *Type of protection: IP-55
- *Insulation Class: "F"- Class
- *Bearing: Maintenance free Ball Bearing.
- *Permissible ambient temperature: 0 to 60° C
- *High Voltage test according to IS: 3588-1987
- *Balancing Grade: Fans conform 6.3 Grade as recommended by IS 1940-1-2003
- *Direction of rotation: Clockwise, Seen on rotor

*Wiring Diagram :

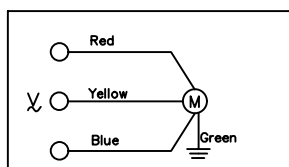

MODEL: BC355-4D-M5

SCALE: NTS | Page 1 of 1

REV/DATE: 02,22.05.2016

PREPARED BY : J.G.P

CHECKED BY : S.B.D

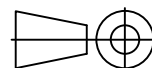

All information contained in this document is CONFIDENTIAL and the property of ROTECH. Reproduction of this any form is to be done with the specific permission of the company.

NOTE: ALL DIMENSIONS ARE IN MM.