

Sucking
Airflow ←

Blowing
Airflow →

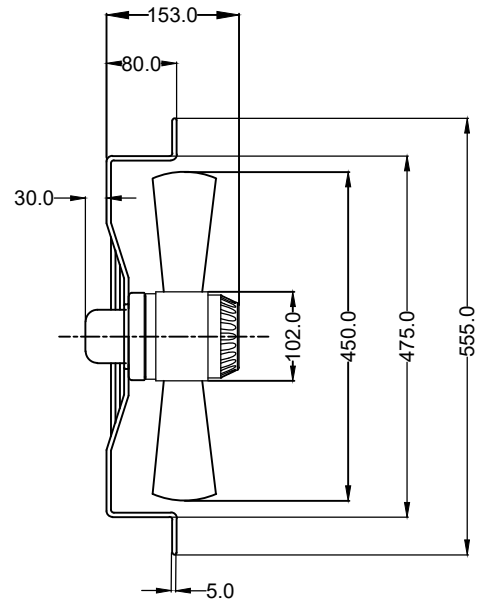

SPECIFICATION (50Hz)

Voltage (V)	230
Watt (W)	250
Amps (A)	1.15
Speed (rpm)	1400
Capacitor (μF)	8.0
Airflow (m ³ /hr)	5400
Noise (dbA)	65
Net Weight (Kg) (With Basket Grill)	7.0

PERFORMANCE CURVE

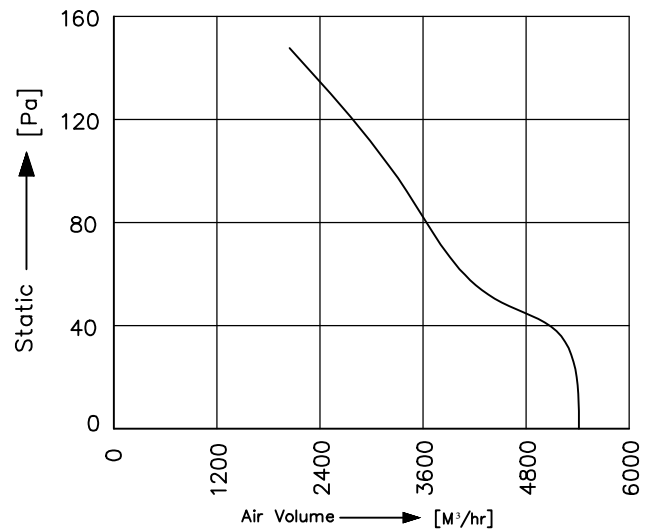

Conversion: 100pa ≈ 0.4" H₂O 100m³/hr ≈ 60cfm

*Material :

- Blade: Steel, powder coated
- Grill: Steel, powder coated
- Rotor: Powder coated
- Frame: Steel, powder coated

*Type of protection: IP-54

*Insulation Class: "F"- Class

*Bearing: Maintenance free Ball Bearing.

*Permissible ambient temperature: 0 to 60° C

*High Voltage test according to IS: 3588-1987

*Balancing Grade: Fans conform 6.3 Grade as recommended by IS 1940-1-2003

*Direction of rotation: Sucking- Counter clockwise

Blowing- Clockwise, Seen on rotor

*Wiring Diagram :

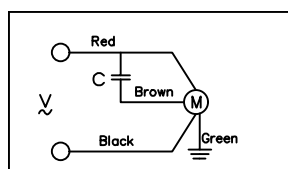

MODEL : AF450-4E-K5

SCALE: NTS | Page 1 of 1

REV/DATE: 04,08.07.2021

PREPARED BY : J.G.P

CHECKED BY : S.B.D

